



# GTi® Millennium HVLP GRAVITY FEED GUN/CUP

Order No. **170156** Model No. **GTI-620G**

**Includes:**

- 1.3 mm, 1.4 mm, and 1.5 mm fluid tips
- 900cc aluminum cup with push-on lid
- HAV-511 high output air adjusting valve with gauge
- Spray gun lube, fluid filter, gun hook



**NEW!**  
Anodized Finish

## HVLP Base Coat/Clearcoat Gun

- Unique air cap design produces painter-friendly pattern
- Excellent value
- Includes three different fluid tips

### GTi® Millennium HVLP Gravity Feed Gun

Order No. Model No.	Type	Fluid Tip (mm)	Inlet Pressure	Application
<b>170156 GTI-620G</b>	HVLP	1.3 & 1.4	20-25 PSI	Base coats
			25-30 PSI	High solids clearcoats, single stages
		1.5	20-25 PSI	Base coats
			25-30 PSI	Low solids clearcoats, single stages

(Includes 1.3 mm, 1.4 mm, & 1.5 mm fluid tips)

### GTi® Millennium Gravity Feed HVLP Air Cap

<b>#2000 air cap HVLP</b>	<b>Base coats, clearcoats, primers, single stage, and low VOC</b>	<b>Air Cap Order No. 192136</b>	<b>Air Cap Pattern</b> 12"
		<b>Air Cap Model No. GTI-407-2000</b>	
<b>Fluid tips</b>	1.2 mm, <b>1.3 mm</b> , <b>1.4 mm</b> , <b>1.5 mm</b> , 1.6 mm, 1.8 mm, 2.0 mm, 2.2 mm (Included tip sizes shown in bold)		



Refer to Service Bulletin: SB-2-168

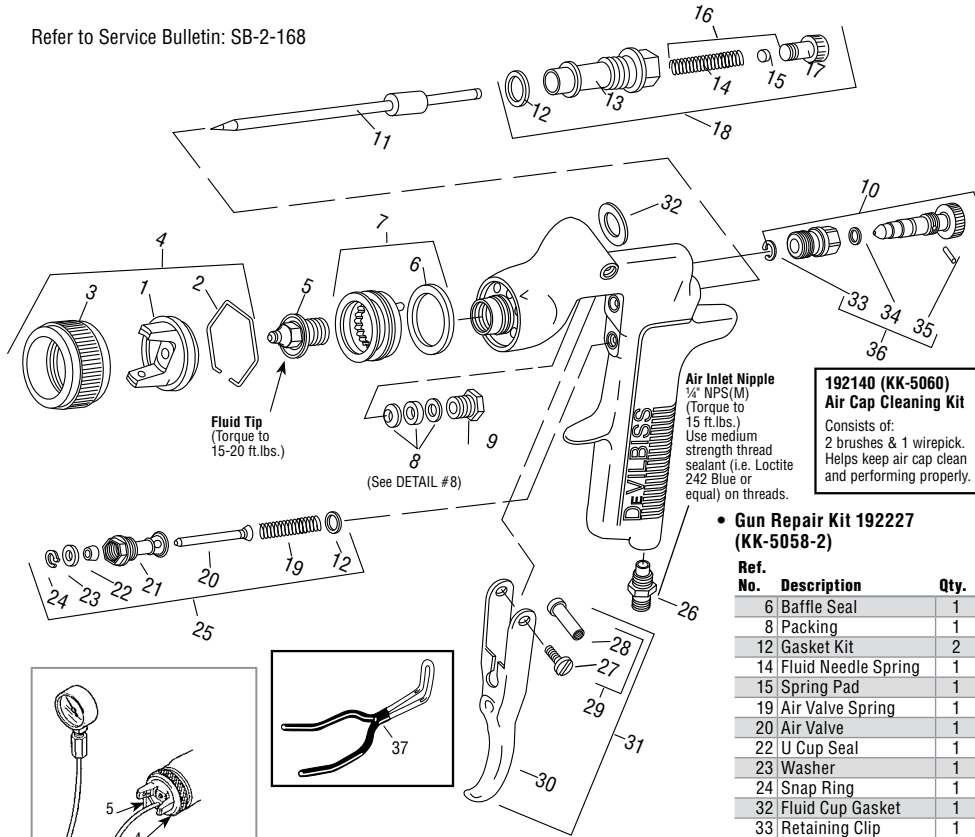

#### • Gun Repair Kit 192227 (KK-5058-2)

Ref. No.	Description	Qty.
6	Baffle Seal	1
8	Packing	1
12	Gasket Kit	2
14	Fluid Needle Spring	1
15	Spring Pad	1
19	Air Valve Spring	1
20	Air Valve	1
22	U Cup Seal	1
23	Washer	1
24	Snap Ring	1
25	190780 JGS-449-1	1
26	190287 P-MB-51	1
27	—	1
28	—	1
29	190889 JGS-478	1
30	—	1
31	191943 JGS-477-1	1
32	192151 KGP-13-K5	1
34	Seal	1
35	Pin	1

#### Setup Information by Paint Brand:

Request DeVilbiss paint company recommendation chart or consult your paint supplier specifications for the material being sprayed.

Ref. No.	Order No.	Model No.	Description	Ind. Parts Req.
1	—	—	Air Cap	1
2	191972	JGA-156-K10	Spring Clip (Kit of 10)	1
3	192042	GTI-3	Air Cap Retaining Ring	1
4	192136	GTI-407-2000	Air Cap (#2000) and Retaining Ring	1
5	See Chart 1	See Chart 1	Fluid Tip	1
•6	192179	GTI-33-K5	Baffle Seal (Kit of 5)	1
7	192178	GTI-425	Baffle Assembly	1
•8	192109	JGA-4035-K5	Packing (Kit of 5)	1
9	190893	34411-122-K10	Packing Nut	1
10	192050	GTI-404	Spreader Valve	1
11	192054	GTI-413	Fluid Needle	1
•12	190161	JGS-72-K10	Gasket Kit (PTFE) (Kit of 10)	2
13	—	—	Body Bushing	1
•14	—	—	Fluid Needle Spring	1
•15	—	—	Spring Pad	1
16	190894	MBD-19-K10	Spring and Pad (Kit of 10)	1
17	192043	GTI-414	Needle Adjusting Screw	1
18	192139	KK-5059	Bushing, Spring, Pad and Knob Kit	1
•19	—	—	Air Valve Spring	1
•20	—	—	Air Valve	1
21	—	—	Air Valve Body	1
•22	—	—	U Cup Seal	1
•23	—	—	Washer	1
•24	—	—	Snap Ring	1
25	190780	JGS-449-1	Air Valve Assembly	1
26	190287	P-MB-51	Air Inlet Nipple 1/4" NPS(M)	1
27	—	—	Trigger Stud Screw	1
28	—	—	Trigger Stud	1
29	190889	JGS-478	Stud and Screw Kit	1
30	—	—	Trigger	1
31	191943	JGS-477-1	Trigger Stud, Screw Kit	1
•32	192151	KGP-13-K5	Cup Gasket (Kit of 5) Blue	1
•33	—	—	Retaining Clip	1
•34	—	—	Seal	1
•35	—	—	Pin	1
36	192229	GTI-428-K5	Clip, Seal & Pin Kit (5 Each)	1
37	192219	—	Gun Holder, Coated	1
38	192140	KK-5060	Air Cap Cleaning Kit	1

• A quantity of necessary parts is included in 192227 Repair Kit (KK-5058-2) for complete gun repair and should be kept on hand for service convenience.

Suffixes: -K5 designates kit of multiple parts. Example: JGA-4035-K5 is a kit of 5 packings.

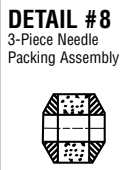

**Chart 1**

Order No.	Fluid Tip Model No.	Tip Size I.D. in.	mm
192124	GTI-213-12	.047	1.2
192134	GTI-213-13	.051	1.3
192044	GTI-213-14	.055	1.4
192135	GTI-213-15	.059	1.5
192045	GTI-213-16	.063	1.6
192046	GTI-213-18	.070	1.8
192047	GTI-213-20	.079	2.0
192132	GTI-213-22	.086	2.2